



PLANNING AND DEVELOPMENT
CURRENT PLANNING DIVISION



9770 CULVER BOULEVARD, CULVER CITY, CALIFORNIA 90232-0507

(310) 253-5710
www.culvercity.org

September 26, 2025

Philip Chauvet
Chauvet Tree Farms Inc.
2793 Botticelli Dr.
Henderson, NV 89052

NOTICE OF DECISION: CHAUVET TREE FARM – TEMPORARY USE PERMIT, P2025-0184
11281 Washington Pl in the Mixed-Use Corridor 1 (MU-1) Zone

Dear Philip Chauvet:

The Current Planning Division has conditionally approved your Temporary Use Permit, P2025-0184-TUP, to operate a seasonal tree lot at the project site. The approval is subject to the outlined conditions in Attachment 1.

This administrative decision may be appealed in accordance with Title 17, Section 17.640.030 Appeals, by any interested person within 15 calendar days of approval, by 5:30 PM.

For any inquiries, please contact Reese Hammons, Planning Technician, at (310) 253-5712 or reese.hammons@culvercity.org.

Sincerely,

Mark E. Muenzer
Planning and Development Director

Enclosures:

1. Attachment 1 – Analysis and Conditions of Approval
2. Attachment 2 – Site Plan
3. Attachment 3 – Community Risk Reduction – Outdoor Assembly and Special Event Guidelines

Copy: Timothy Koutsouros, Building Official
Dave Montgomery, Fire Prevention Specialist
Daniel Nembhard, Fire Inspector
Marian Aspnes, Enforcement Services Manager
Decision Letter Binder

ATTACHMENT 1

Temporary Use Permit P2025-0184-TUP 11281 Washington Place Analysis and Conditions of Approval – Chauvet Tree Farms Inc.

Request

A temporary use permit (TUP) application was submitted on July 29, 2025, requesting permission to operate a seasonal tree lot at the project site. The proposed dates of operation will be November 1, 2025, through January 5, 2026, including setup and cleanup, with actual tree sales occurring from November 28, 2025, to December 24, 2025.

Background

Culver City Municipal Code (CCMC) Title 17, Chapter 17.520 requires approval of a TUP for temporary seasonal uses and activities. The project site is a square-shaped parcel located at the northeast corner of the intersection of Sawtelle Boulevard and Washington Place.

Analysis

Culver City Municipal Code (CCMC) Title 17, Chapter 17.520 requires approval of a TUP for temporary seasonal uses and activities. The applicant proposes to begin set up for the tree sales on November 1, 2025, and will commence tree sales from November 28, 2025, through December 24, 2025, operating from 9:00 AM to 9:00 PM daily. All equipment, merchandise, and refuse will be removed, and the site restored to its original condition, by January 5, 2026. The site is approximately 12,200 square feet and will include a tree display and sales area and a prep area for the cutting of trees. A 6-foot-tall chain-link fence is proposed throughout the perimeter.

Parking and loading will be provided on the site. Approximately 10 spaces will be provided to serve the use. The seasonal tree lot is expected to attract approximately 20 visitors a day on weekdays and 45 visitors a day on weekends. The City has determined that the provided parking will be sufficient to serve the average number of expected daily visitors with conditions of approval implemented.

Findings

The following findings for a temporary use permit have been made pursuant to CCMC Section 17.520.030:

A. The use is limited to a duration that is no more than the maximum allowed duration, as determined appropriate by the review authority.

The Applicant's proposed dates of operation are November 1, 2025, to January 5, 2026. The duration of the proposed temporary use, including setup, cleanup, and event activities are consistent with the provisions of Section 17.520.015.A.3 of the CCMC, which states seasonal sales activities may be approved for up to 30 days or as determined appropriate by the review authority.

B. The site is physically adequate for the type, density, and intensity of use being proposed, including provision of services (e.g. sanitation and water), public access and the absence of physical constraints.

The subject site is a vacant lot measuring approximately 12,200 square feet and is adjacent to existing roadways and sidewalks. Temporary utilities will be provided on-site, and the applicant must obtain all necessary permits from Building Safety. Based on the

size and topography of the site, surrounding public access, and provision of temporary utilities and amenities, the site is physically adequate to accommodate the placement of a seasonal tree lot use.

C. The design, location, size, and operating characteristics of the proposed use are compatible with the existing land uses on-site and in the vicinity of the subject property.

The proposed location of the seasonal tree lot use is near the intersection of Washington Place and Sawtelle Boulevard, where the surrounding uses consist of a mix of commercial and residential uses, with which the proposed use is compatible. The parking provided will accommodate the expected number of daily visitors to the site. The nearest residential uses about the site and based on the operations and with the conditions of approval, the proposed temporary use will not affect the residences.

D. The temporary use will be removed and the site restored as necessary to ensure that no changes to the site will limit the range of possible future land uses otherwise allowed by this Title.

The operation of the temporary seasonal tree lot use and the proposed temporary improvements on the subject site will not result in any permanent changes to the physical layout or character of the site. All improvements related to the seasonal tree lot use will be removed no later than January 5, 2026, and the site will be restored to its original condition. Further, no part of the proposed temporary use will affect the range of possible future land uses.

E. The use will comply with all applicable provisions of local, State, and Federal laws or regulations.

The proposed temporary use, including the installation of any temporary improvements, is required to comply with all applicable regulations, including all applicable local, State and Federal laws or regulations, and shall not interfere with any other activities on the surrounding properties subject to the conditions of approval listed herein, below.

F. In order to ensure public health, safety, and welfare, certain conditions of approval are necessary.

Various conditions applicable to this Temporary Use Permit have been determined necessary to ensure the health, safety, and welfare of the community and are made part of this approval as listed herein, below.

Environmental Determination

Pursuant to the project description and the California Environmental Quality Act (CEQA) as amended, the Current Planning Division determined the Project is Categorical Exempt pursuant to Section 15304(e), Class 4 – Minor Alterations to Land, because the seasonal tree lot is considered a minor temporary use of land having negligible or no permanent effects on the environment.

Conditions of Approval

Based upon the authority provided for in CCMC Section 17.520.030, Temporary Use Permit, P2025-0184-TUP is hereby approved subject to the following conditions:

1. The proposed temporary use shall:
 - a. Be developed as outlined in the attached proposed site plan; and
 - b. Be subject to the terms of conditions as outlined in the CCMC and as further modified by the conditions listed herein below.
2. The seasonal tree lot use will be allowed on site November 1, 2025 through January 5, 2026, including setup and cleanup, and shall open for business from November 24, 2025 through December 24, 2025 ("operating period"). The period of the TUP before and after the operating period shall be used for setup and cleanup/take-down activities only.
3. The seasonal tree lot will be allowed to operate for business daily from 9:00 AM to 9:00 PM during the operational period of November 28 through December 24, 2025.
4. The applicant shall apply and pay for all other applicable City permits for the installation of all temporary improvements and equipment including, but not limited to, the following:
 - a. A business tax certificate from the City Treasurer's office.
 - b. Building and electrical permits from the Building Safety Division, as necessary.
 - c. Permits for all structures over 400 square feet from the Community Risk Reduction Division.
 - d. One or more trash dumpster permits from the Environmental Programs and Operations Division, if applicable and as necessary.
 - e. Special Event Permit from the City's Committee on Permits and Licenses.
5. The applicant will perform a perimeter check two times a day to ensure that no debris or trash from the operation is in the public right-of-way. At the end of each business day, the applicant shall remove all trash and debris resulting from the operation from the subject site and immediately adjacent sites.
6. Lighting shall not create glare and shall be directed onto the project site, away from the site perimeter. Lighting shall be shielded to prevent spillover onto abutting properties and public rights-of-way.
7. The proposed operation shall comply with all applicable provisions of local, State and Federal laws, code requirements, and regulations.
8. All project-related solid and recyclable waste material handling shall be in accordance with CCMC Section 5.01.010 - "Solid Waste Management," which outlines the Environmental Programs-and-Operation-Division's-exclusive-franchise-for-services.
9. The project shall provide adequate trash, recycling, and organics waste capacity and comply with Assembly Bill 939, 1826, and 341 and SB1983 waste diversion goals and all City requirements.
10. The proposed special event will be required to house a 3 yd. bin for trash and 2 yd. bin for organic waste. Applicant shall coordinate all bin rentals through Environmental Programs

and Operations Division's Sanitation Office at (310) 253-6400, 2 weeks prior to start of the event.

11. Should there be a use of the sound-amplifying equipment, the applicant shall file an application with the Committee on Permits and Licenses at least 10 days prior to the day on which the sound-amplifying equipment is to be used.
12. The applicant shall comply with the City's noise ordinance. The operation of generators, if any, will be limited to the hours of operation. The applicant understands their operation is adjacent to commercial uses and residential properties and shall operate at noise levels not deemed to be a nuisance.
13. Per the City's noise ordinance, the operation of sound amplifying equipment, if any, shall occur only between the following hours:
 - 8:00 AM through 8:00 PM Monday through Thursday, 8:00 AM through 10:00 PM Friday,
 - 10:00 AM through 10:00 PM Saturday,
 - 10:00 AM through 8:00 PM Sunday and City specified holidays.
14. The applicant shall prohibit the presence, sale, or consumption of alcoholic beverages at the subject site by its staff, visitors, and customers.
15. Signs facing the public right-of-way shall be installed per the Municipal Code. The City reserves the right to request the removal of any sign which has not been approved and remove any sign upon 24-hour written notice. No freestanding signs shall be placed outside of the fence on the sidewalk, street, or alley.
16. The City reserves the right to periodically inspect the premises without prior notification to ensure ongoing compliance with all conditions of approval.
17. Pursuant to CCMC Chapter 17.660, the City reserves the right to revoke or modify this approval of the Temporary Use Permit at any time if any non-compliance with the Conditions of Approval is found, or if it is determined that the improvement/use allowed by the permit has become detrimental to the public health, safety, or general welfare, or the manner of operation constitutes or creates a nuisance.
18. All improvements, trash, and debris within the subject site and perimeter shall be cleared no later than 10:00 PM on January 5, 2026.
19. The applicant shall contact Community Risk Reduction (communityriskreduction@culvercity.org) for a Fire Department permit.

C HAUVET Tree Farms INC
11281 WASHINGTON PLACE
CULVER CITY, 90230
ALLEY 125'

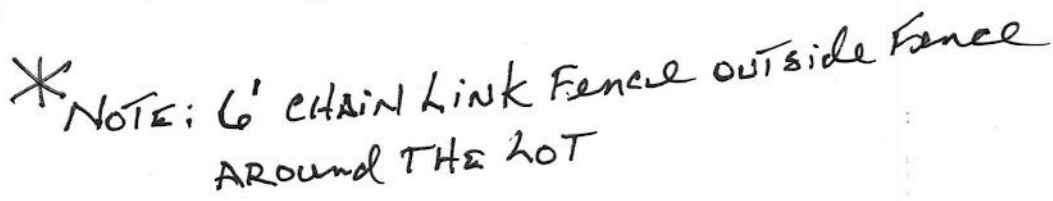

FIRE DEPARTMENT



(310) 253-5925

KENNETH POWELL
Fire Chief

9770 CULVER BOULEVARD, CULVER CITY, CALIFORNIA 90232-0507

CHRIS MILLER
Fire Marshal

COMMUNITY RISK REDUCTION DIVISION

Outdoor Assembly and Special Event Guidelines

Purpose

The purpose of these guidelines is to provide information regarding fire and life safety requirements for outdoor assembly special events.

Note: *This information is being provided by the Culver City Fire Department as a summary of the 2022 California Fire Code (CFC) which is adopted by City Ordinance in the Culver City Municipal Code. This information is intended to be used as a quick reference guide. It is not all inclusive and does not supersede other adopted codes and regulations.*

General Requirements

Operational Permit

Outdoor assembly events shall be approved by CCFD Community Risk Reduction (CRR) per CFC 3106.2.1. An operational permit shall be required for Outdoor Assembly Events as set forth in CFC 105.6. *CFC 3106.2.2*

Occupant Load

The occupant load shall be assigned by CCFD CRR. Every room or space which is used for assembly, classroom, dining, drinking, or similar purposes having an occupant load of 50 or more shall have the occupant load of the room or space posted in a conspicuous place, near the main exit or exit access doorway from the room or space. Posted signs shall be of an approved legible permanent design and shall be maintained by the owner or the owner's authorized agent. *CFC 1004.3*

Crowd Managers

Where events involve a gathering of more than 1,000 people, trained crowd managers shall be provided at the Fire Marshal's discretion in accordance with Section 403.12.3. *CFC 3106.4.3*

Weather Monitoring

The event sponsor shall designate one qualified person to continuously monitor local weather reports, forecasts and conditions. This person will be responsible for initiating weather-related event mitigation activities and if necessary, cancel the outdoor assembly event. An evacuation signal per the approved public safety plan may need to be issued. *CFC 3106.4.2*

Smoking

Smoking shall be permitted only in designated areas. Other areas shall have approved “No Smoking” signs conspicuously posted and maintained in accordance with Section 310. *CFC 3106.4.5*

Combustible Refuse

Combustible refuse shall be kept in noncombustible containers with tight-fitting or self-closing lids. Combustible refuse shall be removed from the event site at regular intervals to prevent an unsafe accumulation within the event. *CFC 3106.4.7*

Roles and Responsibilities

Event Sponsor

- ✓ Obtain the proper permits from the City of Culver City (open flame, tents, cooking tent, proximate audience pyrotechnics).
- ✓ Provide a site plan to CCFD CRR upon request showing:
 - The location of stages, non-food booth vendors, food vendors and display areas.
 - Locations of emergency exits.
 - Ensure access to fire hydrants will be maintained clear and unobstructed. A clear space of 3 feet shall be maintained in all directions.
- ✓ The Event Sponsor shall distribute to each hot food vendor a copy of the *Fire Safety Requirements for Hot Food Vendors*.

Event Vendors

- ✓ Fire protection equipment and systems access clear and unobstructed.
- ✓ Read, understand and adhere to the *Fire Safety Requirements for Hot Food Vendors*.
- ✓ Be prepared at any time for a fire inspection.

Fire Department Inspectors

The CCFD inspectors are responsible for inspecting events in which a site inspection is deemed necessary prior to the opening of the event. The inspectors will issue correction notices when non-compliant conditions needing correction are found and will re-inspect to ensure compliance.

The fire department inspections shall include, but are not limited to the following:

- ✓ Hot food vendor booths
- ✓ Fire department and emergency apparatus access
- ✓ Access to fire hydrants, fire department connections, and fire control rooms
- ✓ Event egress
- ✓ Propane tank placement and security
- ✓ Pyrotechnics and open flame effects

- ✓ Tents requiring a permit
- ✓ Generator placement and use
- ✓ Proper flame-retardant treatment of decorative materials

Fire Protection Equipment and Systems

Fire hydrants, fire extinguishers and fire protection components shall be maintained operational and accessible at all times. *CFC 3106.2.3.1*

Fire extinguishers shall have a minimum 2-A:10-B:C rating. They shall have a current service tag provided by a State Fire Marshal approved fire extinguisher service company or proof of purchase within the previous 12 months.

Fire extinguishers shall be located within 75 feet of travel distance from anywhere within the space. They shall be properly mounted and shall be visible and accessible at all times. Clearly identify locations with signs or reflective tape. *CFC 3106.4.4*

Fenced Events: Access and Egress

Number of Exits:

A fenced outdoor assembly occupancy shall have not less than two remote means of egress for the enclosure in accordance with NFPA 101 7.5.1.3, unless otherwise required by one of the following:

1. If more than 6000 persons are to be served by such means of egress, there shall be not less than three means of egress.
2. If more than 9000 persons are to be served by such means of egress, there shall be not less than four means of egress.

2018 NFPA 101 12.2.4.4

*The number and location of emergency egress and escape routes shall be approved by CCFD CRR.

Exit Spacing and Location

Exits shall be equally spaced along the perimeter of the fence. The exits shall be spaced so that all points are 100 feet or less from an exit.

Exit Dimensions

Exit width shall provide an opening of no less than 48 inches wide and 84 inches high.

Exit Staffing

Each exit shall have a member of the event staff or security assigned and posted to it. The event sponsor shall provide a gate assignment roster upon request. Panic hardware installed on outward swinging doors can be utilized in lieu of staffing.

Exit Identification

Each exit shall be identified by use of approved exit signs on the interior side of the fence.

Means of egress illumination shall be provided. Exit signs shall be either listed and labeled in accordance with UL 924 as the internally illuminated type and used in accordance with the listing or shall be externally illuminated by luminaires supplied in either of the following manners:

1. Two separate circuits, one of which shall be separate from all other circuits for occupant loads of 300 or less.
2. Two separate sources of power, one of which shall be an approved emergency system, shall be provided where the occupant load exceeds 300.

Fire Safety Requirements for Hot Food Vendor Booths

General Requirements

The fire safety of these booths falls under the jurisdiction of the Fire Department. The following fire safety requirements apply to the individual vendor freestanding booths. All food vendors are subject to inspection prior to an event. Failure to comply with the following requirements may result in closure of the individual food booth until reasonable compliance is achieved.

Heating & Cooking Equipment

Installation: as specified in the *California Mechanical Code* and the *International Fuel Gas Code*. ***Installation shall be approved by the Fire Department. *CFC 3107.12.1*

Venting: to outside air of fuel-burning equipment as specified in the *International Fuel Gas Code* and the *California Mechanical Code*. Vents to be equipped with approved spark arresters where required and not less than 12” from all portions of the tent or membrane structure. *CFC 3107.12.2*

Location: Cooking and Heating Equipment shall not be located within 10 feet of exits or combustible materials. *CFC 3107.12.3*

Electrical Heating and Cooking Equipment: shall comply with the *California Electrical Code*. *CFC 3107.12.7*

LP-Gas: Portable LP-gas containers are prohibited indoors and in tents. Portable LP-gas containers with a capacity of 500 gallons or less shall have a minimum separation between the containers and tent(s) not less than 10 feet; more than 500 gallons not less than 25 feet.

Containers shall be protected to prevent tampering, damage, or tipping over.

LP-gas equipment shall be approved and in accordance with CFC Chapter 61 and *the California Plumbing Code*. CFC 3107.13.1

***Event Sponsor to provide approved storage for any additional LP-gas (propane) tanks to be used by the food vendors.

Open or Exposed Flame: charcoal burners, open-flame cooking devices, open flame or any device emitting flame or spark shall not be used in or located within 20 feet of any tent while open to the public, unless approved by the Fire Marshal. CFC 3107.4shall not be operated within 10 feet of combustible construction. CFC 308.1.4

Portable Fire Extinguishers

A portable fire extinguisher shall be provided for each food booth and shall be placed in an accessible and visible location near the cooking area. Fire extinguishers shall have a minimum rating of 2-A:10-B:C. If cooking involves the use of a deep fat fryer, a Type K wet chemical fire extinguisher shall also be provided. Fire extinguishers shall have a current service tag provided by a State Fire Marshal approved fire extinguisher service company or proof of purchase within the previous 12 months.

Location of Cooking Equipment

1. Location of Cooking Equipment Outside of Tents

Grease-laden Vapors, Sparks, or Flying Embers: outdoor cooking that produces sparks or grease-laden vapors or flying embers (firebrands) shall not be performed within 20 feet of a tent or temporary structure. This includes but not exclusive to deep fat fryers, grills, griddles and solid fuel. CFC 3107.12.6

Exceptions:

- (1) Tents or structures where cooking appliances are protected with an automatic fire extinguishing system in accordance with Section 904.12.
- (2) Designated Cooking Tents: not occupied by the public when approved by the Fire Marshal. A permit will need to be obtained from Community Risk Reduction. CFC3106.5.1

Cooking Tents: Tents with sidewalls or drops where cooking is performed. Cooking tents shall be separated from other tents or membrane structures by not less than 20 feet and shall not be occupied by the public. CFC 3107.12.5

****Hazardous cooking in tents may be allowed by the Fire Marshal on a case by case basis.**

- ✓ A permit will need to be obtained from Community Risk Reduction.
- ✓ Cooking must be performed in designated cooking tents.

Deep fat fryers and Cooking Equipment Using Combustible Oils or Solids: They shall be used on a solid noncombustible surface to prevent falling or tipping. A noncombustible lid shall be immediately available. The lid shall be of sufficient size to

cover the cooking well completely. Physical guards or fencing shall be utilized to limit contact by the public. *CFC 3106.5.2*

2. Location of Cooking Equipment Inside of Tents

Operations such as warming of food, cooking demonstrations and similar operations that use solid flammable, butane or other similar devices that do not pose an ignition hazard, shall be approved. *CFC 3107.12.4*

Tents & Membrane Structures

Tent Definition: A structure, enclosure or shelter, with or without sidewalls or drops, constructed of fabric or pliable material supported by any manner except by air or the contents that it protects. Compliance with the 2019 California Fire Code Chapter 31 is required for all tents and membrane structures.

Membrane Structure Definition: An air-inflated, air supported, cable or frame-covered structure as defined by the California Building Code and not otherwise defined as a tent. Compliance with 2019 California Fire Code Chapter 31 is required for all tents and membrane structures.

Tents with one or more sides over 400 sq. ft. and tents without sides over 700 sq. ft. are required to be permitted through CCFD Risk Reduction.

Information Required with the Tent Permit Application

- ✓ **Certificate of Flame Retardant** (The structure shall have a permanently affixed label indicating compliance with flame propagation requirements).
- ✓ **Site map** including an overall and detailed site plan.

Aisles & Seating

When more than 200 loose seats or folding chairs are used, they shall be bonded together in groups of three or more.

Aisles shall not be less than 44 inches in width. Seating row widths shall not be less than 12 inches. Rows shall be increased by 0.3 inch for every additional seat beyond 14, to the maximum of 22 inches.

Portable Generators

- ✓ Generators and other internal combustion power sources shall be separated from tents, membrane structures, or structures by not less than 20 feet. Generators shall be installed not less than 10 feet from combustible material and shall be isolated

from contact with the public by fencing, enclosure or other approved means not less than 3 feet away from the internal combustion source.

- ✓ Generators shall be diesel fuel type.
- ✓ Generators shall not be refueled while they are running. Refueling of hot generators is not permitted.
- ✓ All generators must be grounded and secured.
- ✓ Properly trained personnel shall be assigned to the generator during operation to remedy potential problems with the generator/ electrical should they arise.
- ✓ A minimum 2-A:10-B:C extinguisher is required for each generator.

Electrical

All temporary electrical systems shall be permitted in accordance with the Culver City Building and Safety Division and maintained in accordance with the California Electrical Code.

Outdoor use: Electrical equipment and wiring shall be listed and labeled for outdoor use.

Power strips: Only UL listed power strips with overcurrent protection shall be used when the number of outlets provided is inadequate. Power strips shall be plugged directly into the outlet, and shall not be plugged into one another in series. Electrical cords and connections shall be protected from mechanical damage (foot traffic) and moisture.

String lighting: Manufacturer's installation guidelines shall be followed for the maximum allowable number of string lights that can be connected. When connecting string light together, the total amperage of all string lights shall be calculated to ensure that they do not exceed the amperage for the extension cord and circuit.

Flammable & Combustible Liquids

All flammable and combustible liquids are to be stored outside in an approved flammable liquid storage cabinet; not less than 50 feet from a tent or membrane structure. Refueling shall be performed in an approved location not less than 20 feet from tents or membrane structures.

Portable Outdoor Gas-fired Heating Appliances

Prohibited locations: The storage or use of outdoor gas-fired heating appliance is prohibited in any of the following locations:

- Inside of any occupancy when connected to the fuel gas container.

- Inside of tents, canopies and membrane structures.
- On exterior balconies, except as allowed by section 6.20 of NFPA 58.

Clearance to buildings: Portable outdoor gas-fired appliances shall be located at least **5 feet** from buildings.

Clearance to combustible materials: Portable outdoor gas-fired heating appliances shall not be located beneath, or closer than **5 feet** to combustible decorations and combustible overhangs, awnings, sunshades, or similar combustible attachments to buildings.

Proximity to exits: Portable outdoor gas-fired appliances shall not be located within **5 feet** of exits or exit discharges.

Tip-over switch: Portable gas-fired heating appliances shall be equipped with a tilt or tip-over switch that automatically shuts off the flow of gas if the appliance is tilted more than 15 degrees from vertical.

Guard against contact: The heating element or combustion chamber of portable outdoor gas-fired heating appliances shall be permanently guarded so as to prevent accidental contact by persons or materials.

LP-Gas Containers

Fuel gas containers for portable outdoor gas-fired heating appliances shall comply with the following:

- **Approved containers.** Only approved DOTn or ASME gas containers shall be used.
- **Container replacement.** Replacement of fuel containers in portable outdoor gas-fired appliances shall not be conducted while the public is present.
- **Container capacity.** The maximum individual capacity for gas containers used in connection with portable gas-fired outdoor heating appliances shall not exceed 20 pounds.
- **Indoor storage prohibited.** Gas containers shall not be stored inside of buildings and shall not be located near exit doors or stairways used as a means of egress.

Protection of valves on LP-gas containers in storage: LP-gas container valves shall be protected by screw-on-type caps or collars which shall be securely in place on all containers stored regardless of whether they are full, partially full, or empty. Container outlet valves shall be closed or plugged.

Exposure hazards: LP-gas containers in storage shall be located outside in a manner that minimizes exposure to excessive temperature rise, physical damage, or tampering.

Securing of compressed gas containers, cylinders or tanks: Compressed gas containers, cylinders or tanks shall be secured to prevent falling caused by contact, vibration or seismic activity. This can be accomplished by one of the following methods:

- **Fixed object:** Securing to a fixed object with one or more restraints.
- **Mobile Device:** Securing on a cart or other mobile device designed for the movement of compressed gas containers, cylinders or tanks.
- **Cabinet:** Securing to or within a rack, framework, cabinet or similar assembly designed for such use.

***Event Sponsor to provide approved storage for extra LP-gas (propane) tanks to be used by the food vendors.

Decorative Material

Definition: All materials used for decorative, acoustical or other effect (such as curtains, draperies, fabrics, streamers, and surface coverings) and all other materials utilized for decorative effect (such as batting, cloth, cotton, hay stalks, hay bales, straw, vines, leaves, trees, moss and similar items), including foam plastics and other materials containing foam plastics. This includes straw scattered on the ground.

Decorative materials must meet the following criteria:

- ✓ **Flame retardant:** All decorative materials shall be both inherently flame retardant and labeled as such, or shall be treated with a listed flame-retardant material.
- ✓ **Flame test:** Testing shall be done in accordance with Section 803.5 of the CFC.
- ✓ **Placement:** Decorative materials, props and/or performer platforms shall not obstruct, confuse, or obscure exits, exit signs, exit pathways, emergency lighting or any component of fire protection systems and equipment (i.e. fire extinguishers, fire alarm systems, fire sprinklers, etc.).

Hay, straw, shavings or similar combustible materials shall not be located within any tent or membrane structure containing an assembly occupancy. Sawdust and shavings utilized for a public performance or exhibit shall not be prohibited provided that they are treated with a listed flame-retardant material or kept damp at the discretion of the Fire Marshal.

All decorative finishes shall be Class A rated in accordance with the California Building Code.

Smoke Generators

Use of smoke-generating equipment may be restricted if determined to be incompatible with smoke alarm(s). Smoke generator and smoke alarm locations shall be approved by the fire department.

Display of Motor Vehicles

The following conditions must be met for the display of motor vehicles at outdoor assembly events:

- At least one 20-B:C fire extinguisher shall be on hand.
- Disconnect the negative battery cable. **EXCEPTION: Electric vehicles or newer vehicles with computerized systems. Person(s) in charge of vehicle shall secure keys and shall ensure that only authorized persons move or operate vehicle.*
- Ensure e-brakes are set and at least 1 wheel is chocked (i.e. secured from movement) on both sides.
- Fuel in fuel tanks does not exceed one-quarter tank or 5 gallons (19 L), whichever is least.
- Fuel tanks and fill openings are closed and sealed to prevent tampering.
- No fueling of vehicles, boats or other motor craft within the building.
- Oil pan shall be placed under all applicable vehicles.

**Any variance to the requirements listed above shall be approved in writing by the CCFD.*